

LEVEL 2 AREA D FLOOR PLAN

1" = 1'-0"
 0 5 10 15 20 25 30
 DIMENSION SCALE

NOTE
 FOR REFERENCE PLAN
 SEE DETAIL
 A4-N-5

DETAIL A
 SCALE 1/4" = 1'-0"
 A4-N-5

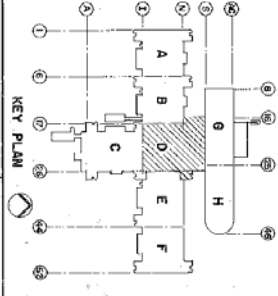

REVISIONS

NO.	DESCRIPTION	DATE	BY	APP'D.
1	ISSUED FOR PERMITS	11/15/83
2
3
4
5
6
7
8
9
10

1. FLOOR (CONC.) SHALL BE 4" THICK WITH ALL REINFORCING BARS AT 12" ON CENTER. REINFORCING BARS SHALL BE #4. ALL REINFORCING BARS SHALL BE TIED TOGETHER AT ALL CORNERS AND INTERSECTIONS. ALL REINFORCING BARS SHALL BE PROTECTED BY 1" MINIMUM CONCRETE COVER.

2. FLOOR JOISTS SHALL BE 12" DEEP WITH 16" SPACING. ALL JOISTS SHALL BE SUPPORTED BY 12" x 12" POSTS AT ALL SPAN POINTS. ALL JOISTS SHALL BE PROTECTED BY 1" MINIMUM CONCRETE COVER.

3. WALLS SHALL BE 8" THICK CONCRETE WITH ALL REINFORCING BARS AT 12" ON CENTER. REINFORCING BARS SHALL BE #4. ALL REINFORCING BARS SHALL BE TIED TOGETHER AT ALL CORNERS AND INTERSECTIONS. ALL REINFORCING BARS SHALL BE PROTECTED BY 1" MINIMUM CONCRETE COVER.

4. CEILING SHALL BE 12" DEEP WITH 16" SPACING. ALL CEILING JOISTS SHALL BE SUPPORTED BY 12" x 12" POSTS AT ALL SPAN POINTS. ALL CEILING JOISTS SHALL BE PROTECTED BY 1" MINIMUM CONCRETE COVER.

5. ROOF SHALL BE 12" DEEP WITH 16" SPACING. ALL ROOF JOISTS SHALL BE SUPPORTED BY 12" x 12" POSTS AT ALL SPAN POINTS. ALL ROOF JOISTS SHALL BE PROTECTED BY 1" MINIMUM CONCRETE COVER.

6. FLOOR FINISH SHALL BE POLISHED CONCRETE.

7. WALL FINISH SHALL BE PLASTER OVER GYPSUM BOARD.

8. CEILING FINISH SHALL BE PLASTER OVER GYPSUM BOARD.

9. ROOF FINISH SHALL BE PLASTER OVER GYPSUM BOARD.

10. ALL FINISHES SHALL BE TO MATCH ADJACENT AREAS.

ATLANTIC DIVISION
205-BED HOSPITAL
PLAN - LEVEL 2, AREA D

FEB 1 1983

4013517
 80091

ARCHITECT: ...
 ENGINEER: ...
 CONTRACTOR: ...